

SW 19 - 49 - 24 - W4

SW 19 - 49 - 24 - W4

Oil Pipeline R/W (862 2753)

Oil Pipeline R/W (952 2031)

SE 19 - 49 - 24 - W4

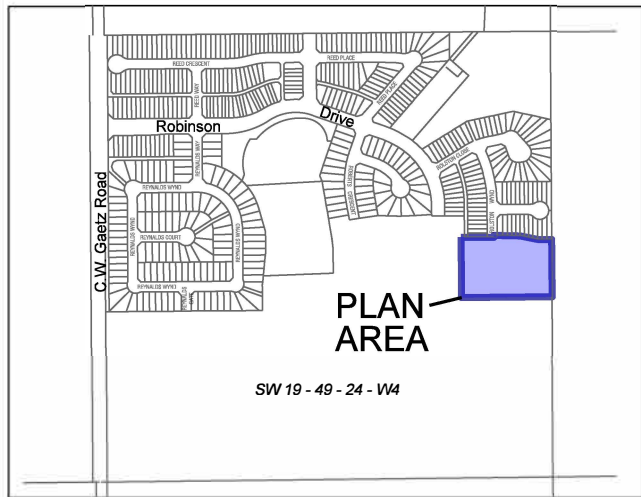

Location Plan N.T.S.

APPROVED

[Signature]

DIRECTOR OF PLANNING & ECONOMIC DEVELOPMENT

File No: PLSDA202001179 Date: Jan. 21, 2021

CITY OF LEDUC SUBDIVISION AUTHORITY

Approval valid for twelve months • Subject to conditions

PROPOSED SUBDIVISION ROBINSON STAGE 10

Part of SW 19 49 24 W4
CITY OF LEDUC

SUBDIVISION BOUNDARY CONTAINING
APPROX. 1.59ha AND 32 DC LOTS

