

Industrial Zone Review Project

Amendment to Land Use Bylaw

Bylaw No. 1171-2024

www.leduc.ca



Industrial Zone Review Project

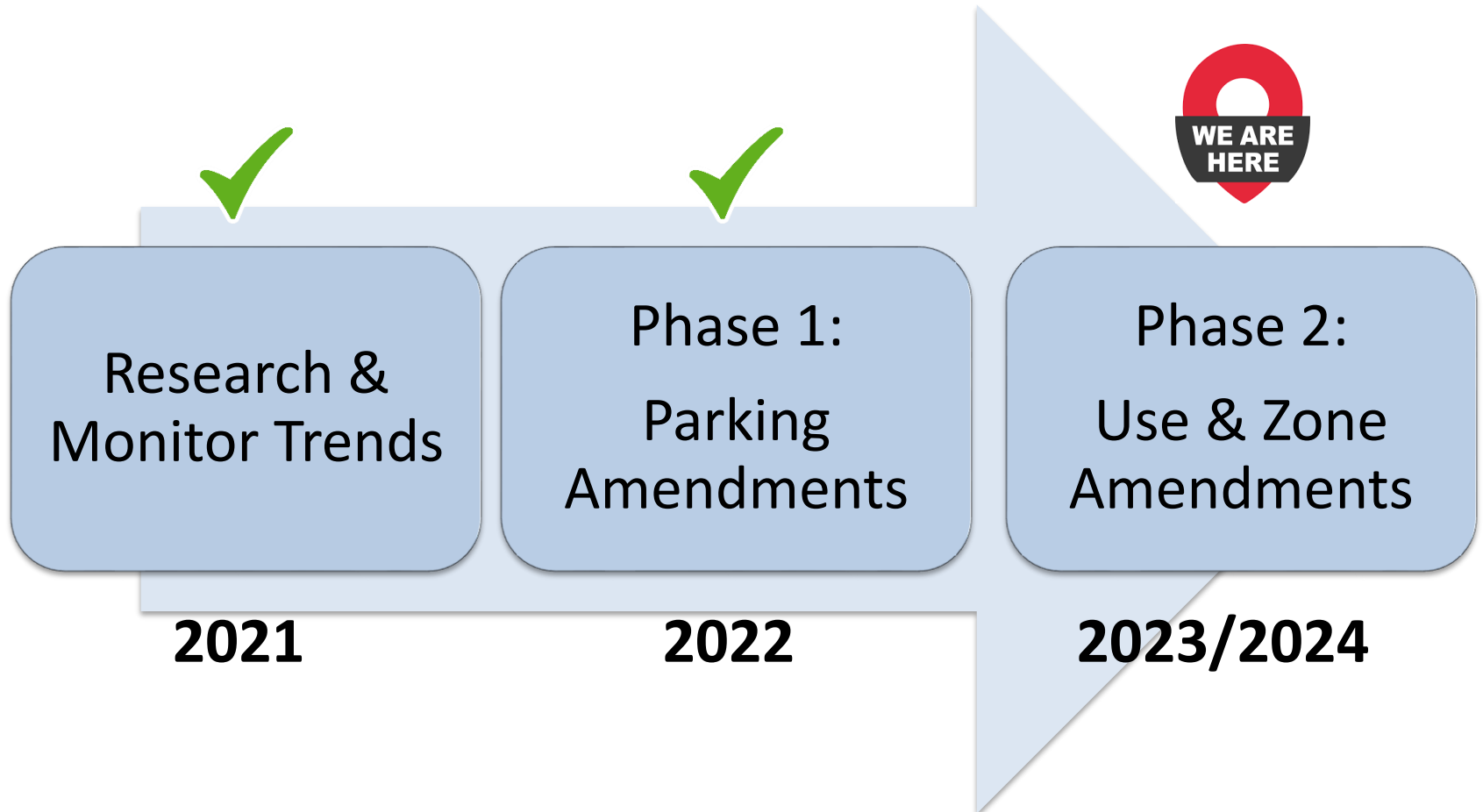

Phase 2 Comprehensive Amendments

Administrative Changes:

- Provide clear, concise & consistent regulations
- Ensure regulations read intuitively
- Correct inconsistencies

Phase 2 Comprehensive Amendments

Consolidation of GC & CSC Districts:

- Removal of CSC District
- Flexible regulations to reduce barriers
- Updated mapping

Phase 2 Comprehensive Amendments

Amendments to GC District:

- Flexible regulations to limit non-conforming:
 - Add 3 uses & modify setbacks
 - Setbacks at Development Authority discretion

Shipping Containers Abutting Railway

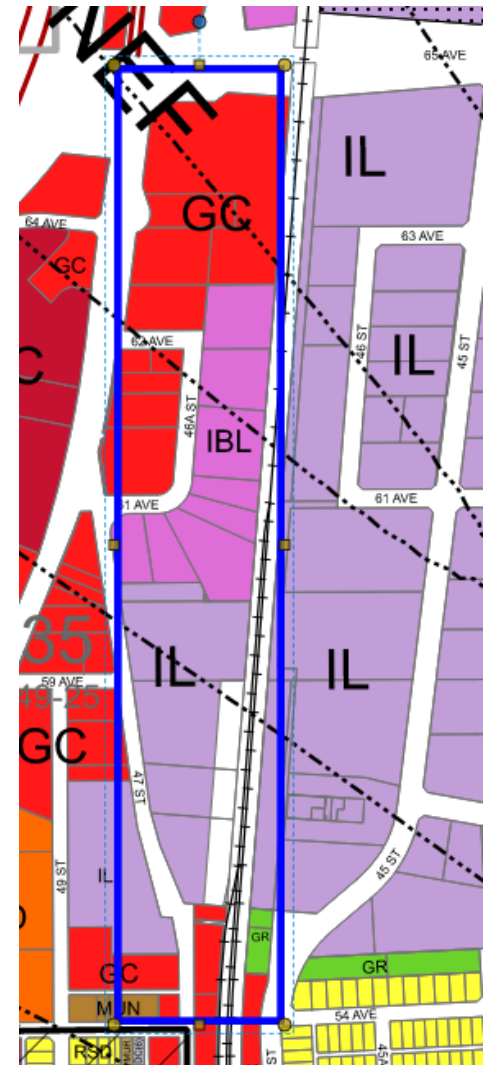
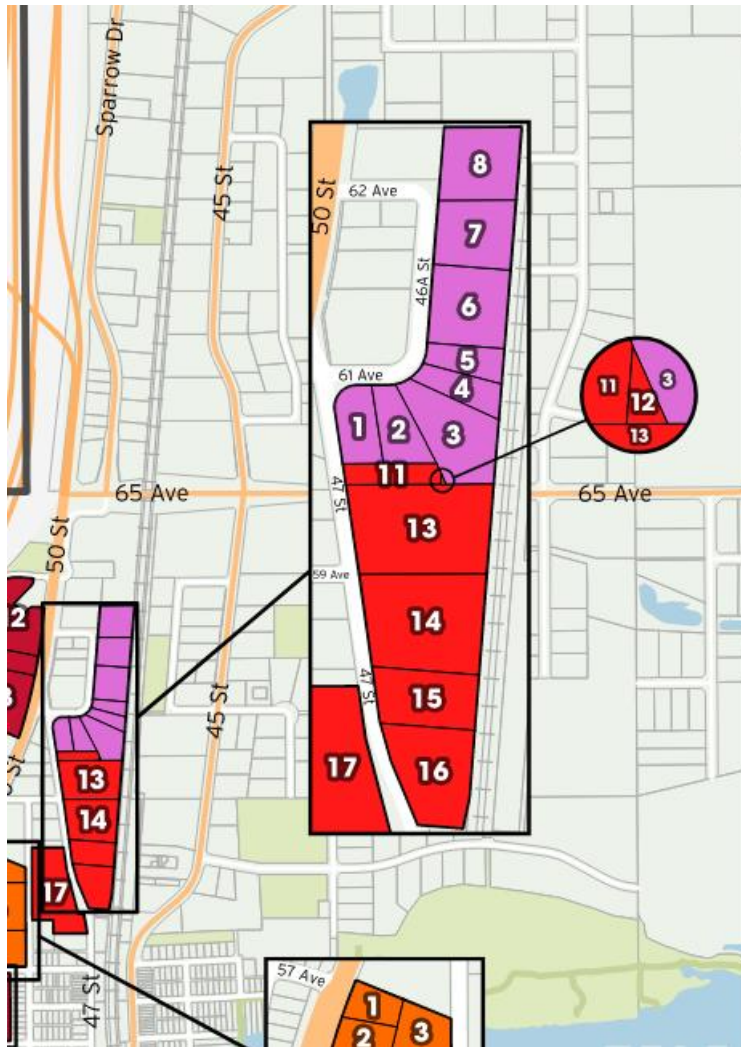

Parking Exemption Abutting Railway

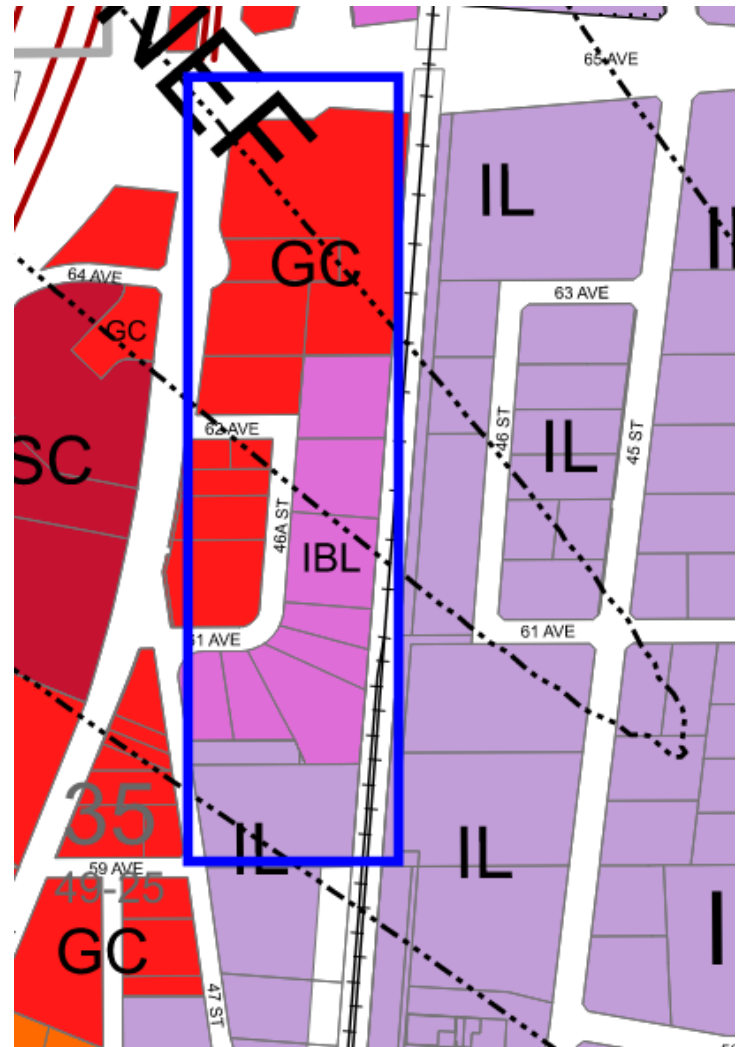
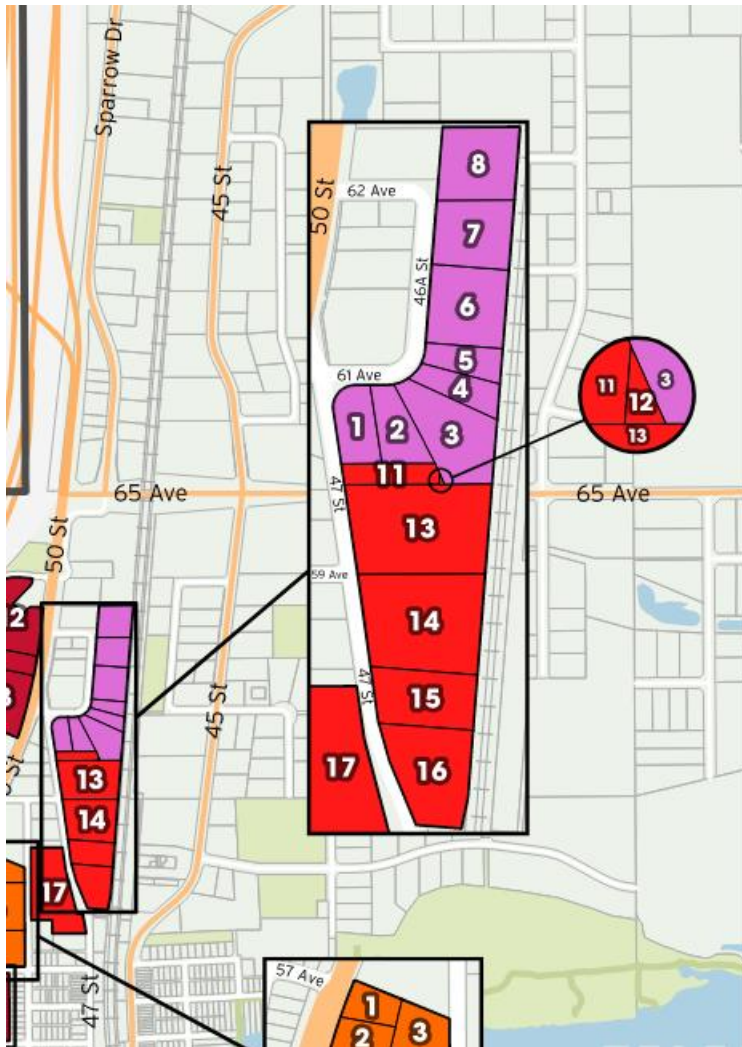

Phase 2 Comprehensive Amendments

Amendments to CBO & IBL District:

- Remove Maximum Site Coverage from CBO
- Allow Shipping Containers in IBL along arterial road
- Modify Service Station definition

Phase 2 Comprehensive Amendments

Amendments to incorporate ASPs:

- Alignment with North Leduc Industrial ASP
- Alignment with East Telford Lake ASP
- Alignment with 65th Avenue ASP
 - Regulations for outdoor operations, storage, and nuisance within these plan areas
 - Increase site coverage in these plan areas

65th Avenue & East Telford Lake ASP Areas

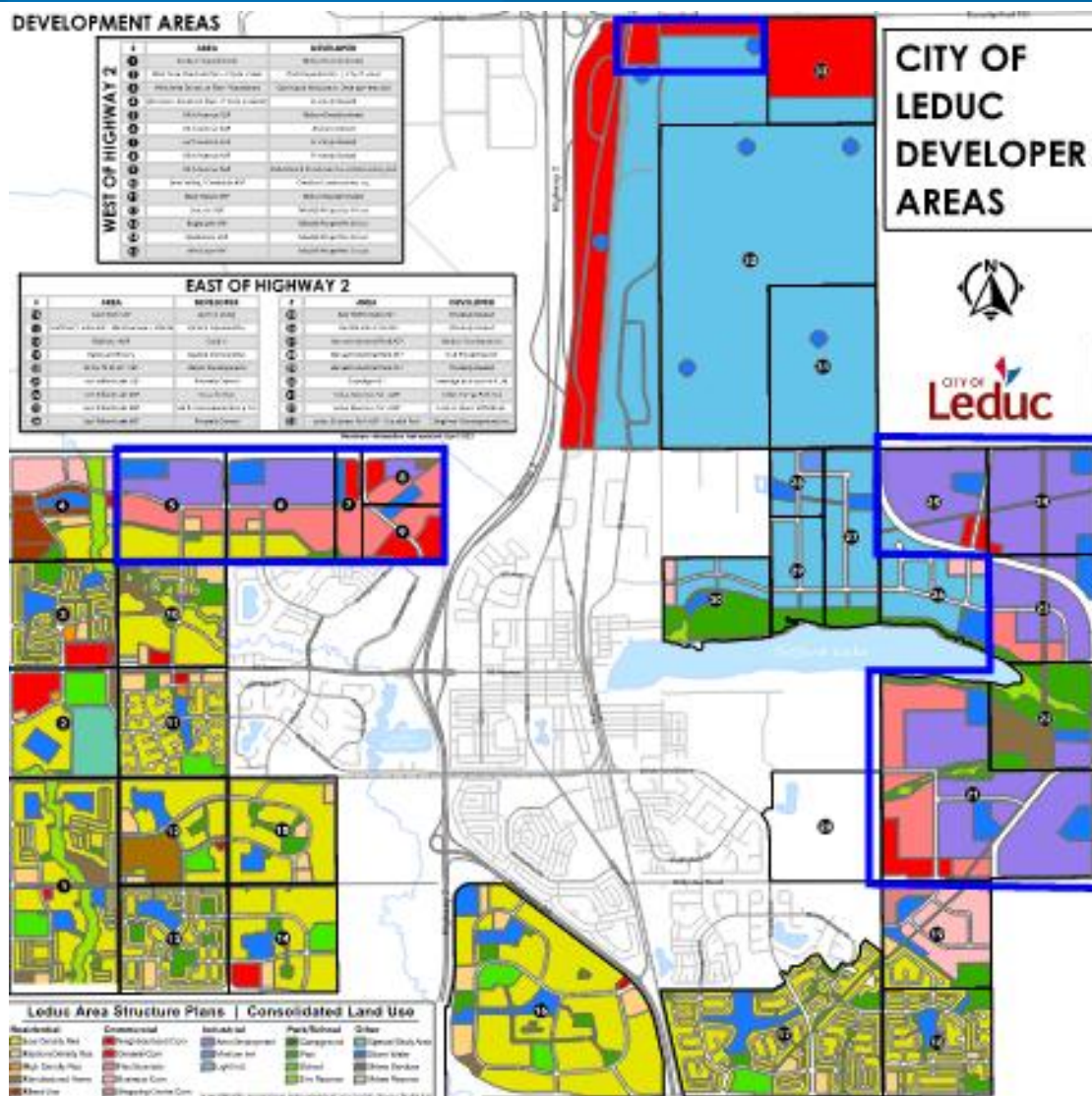

Phase 2 Redistricting

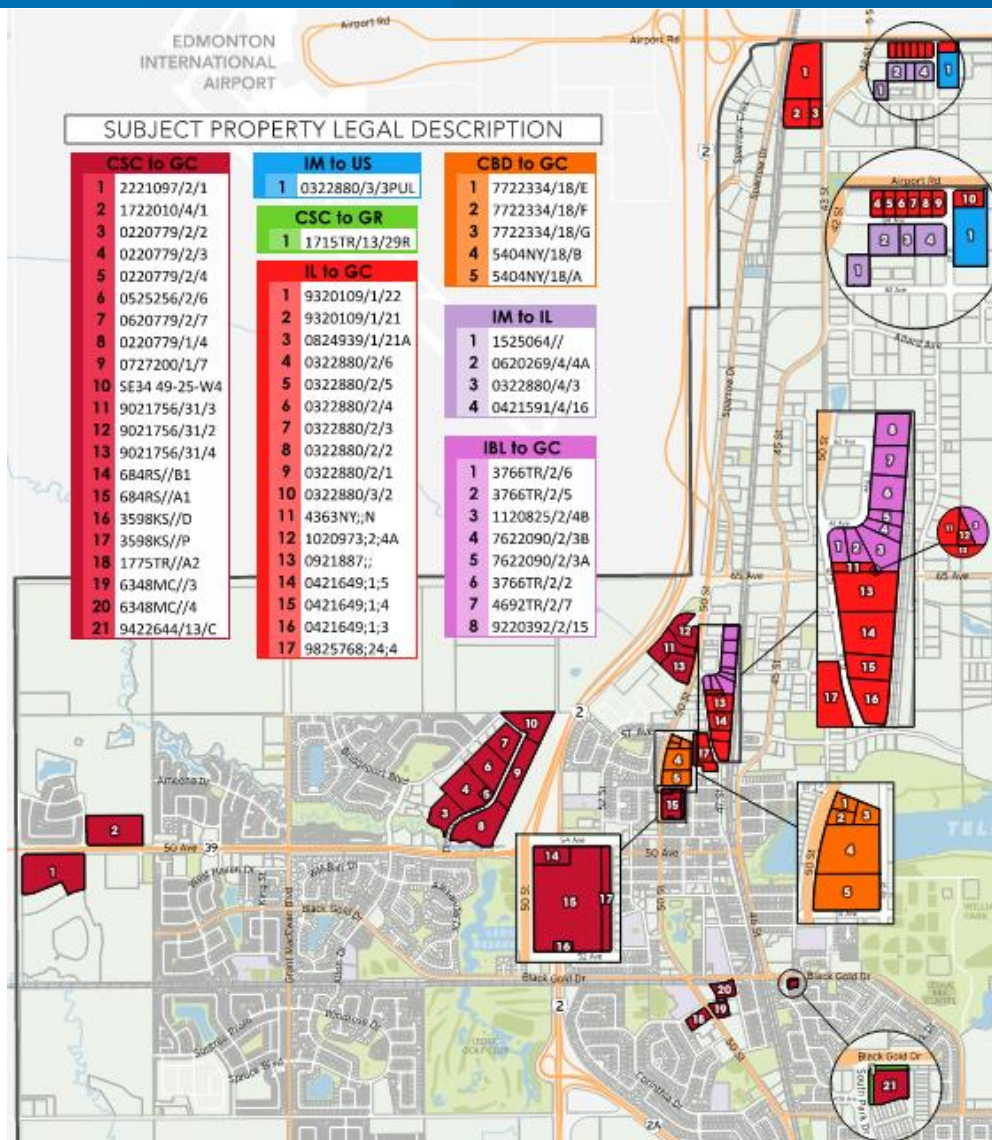

CSC to GC – General Commercial

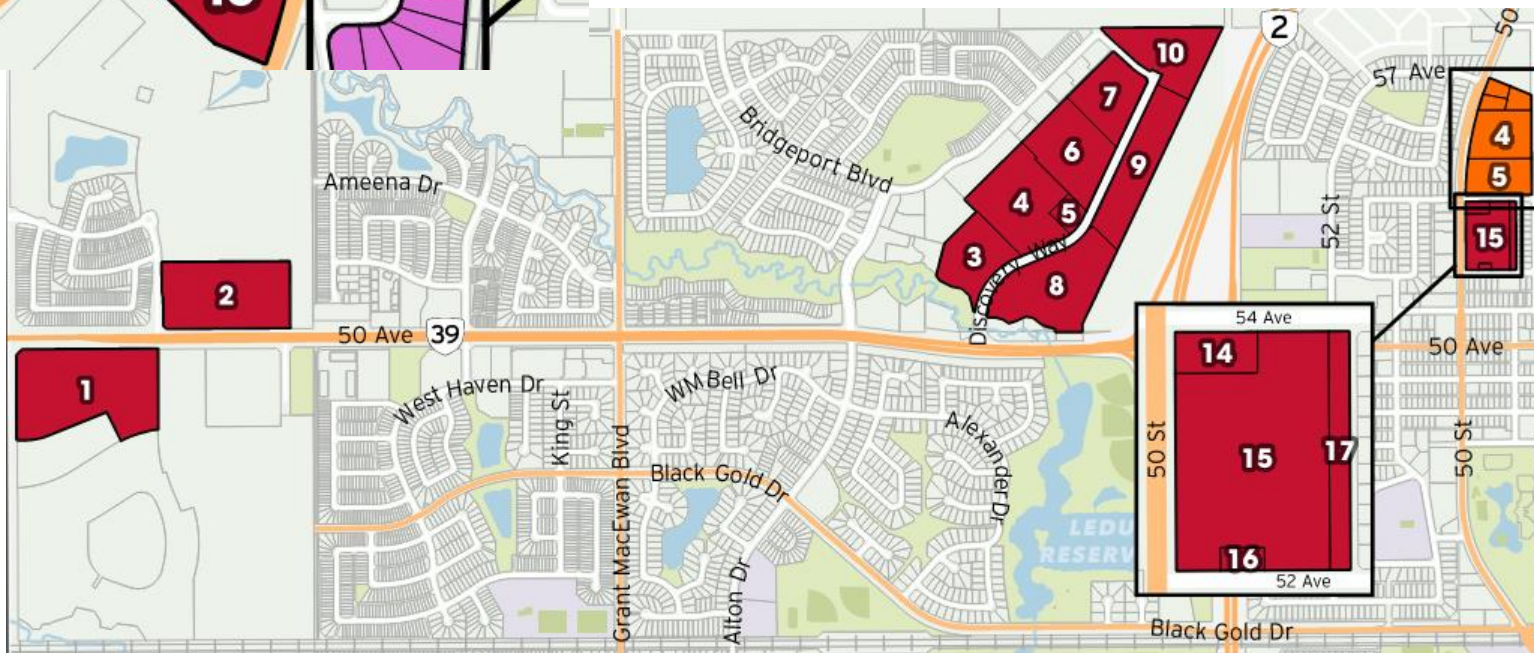
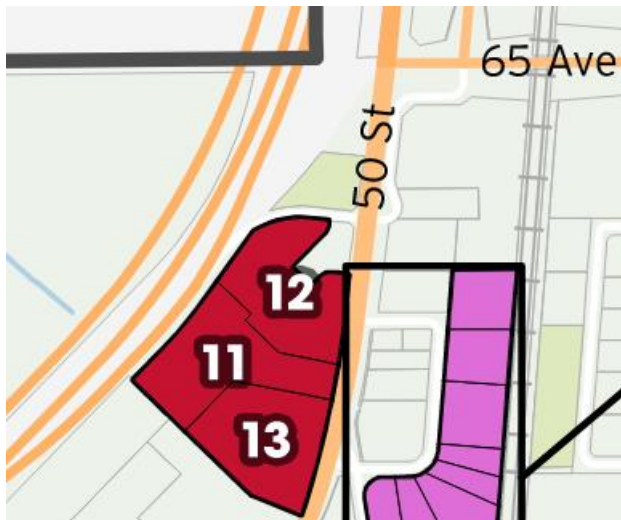

IL to GC – General Commercial

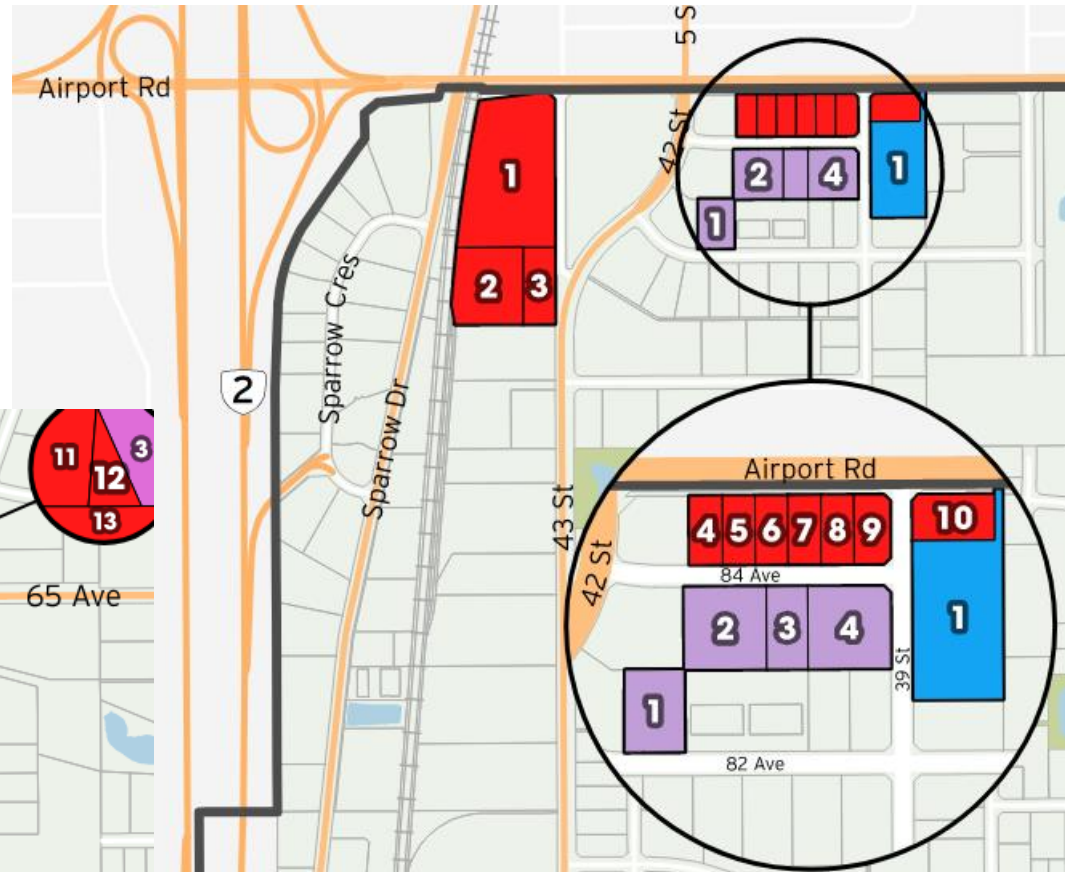
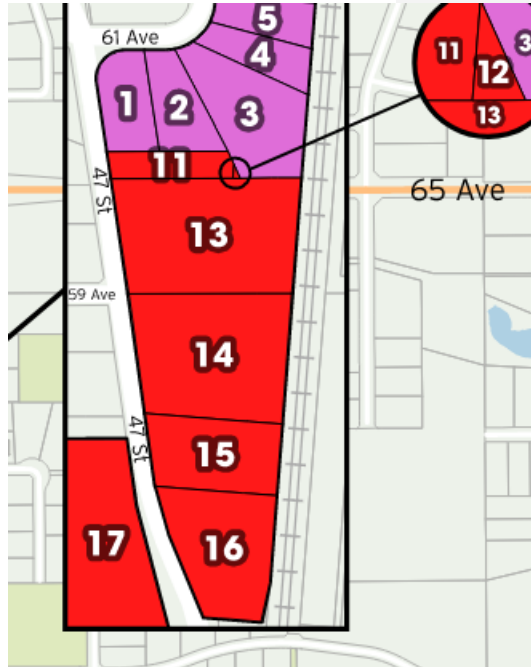
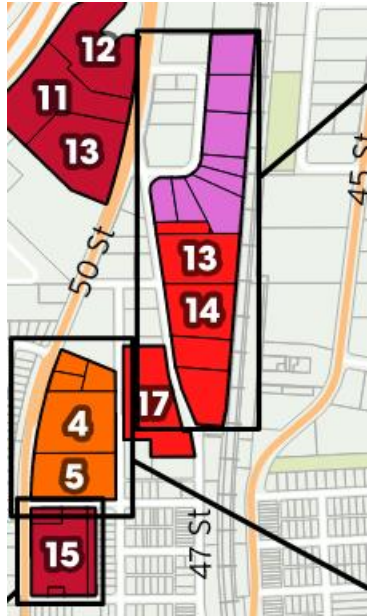

CBD to GC – General Commercial

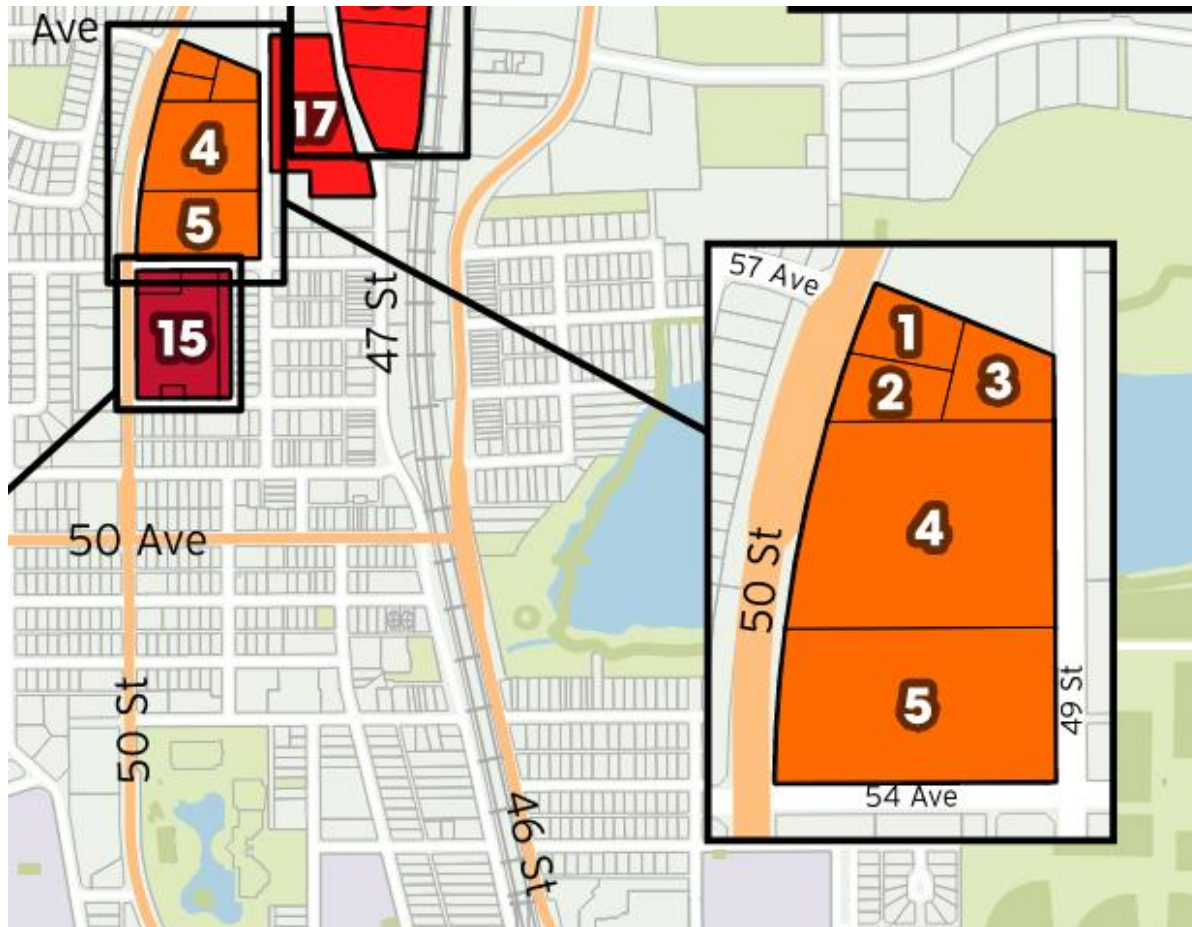

IM to IL – Light Industrial

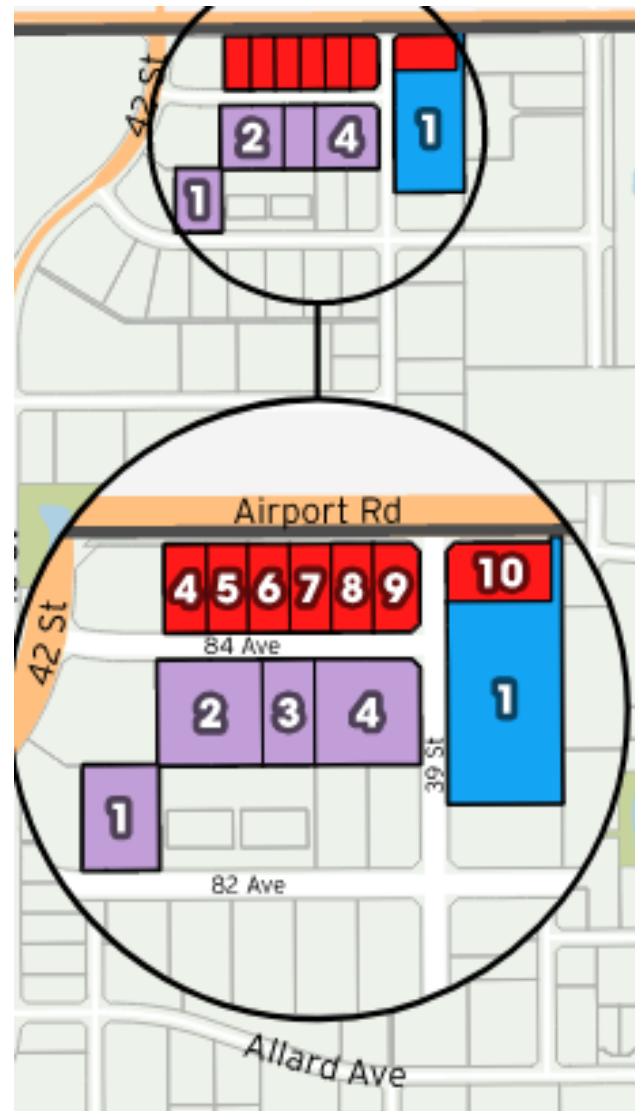

IBL to GC - General Commercial

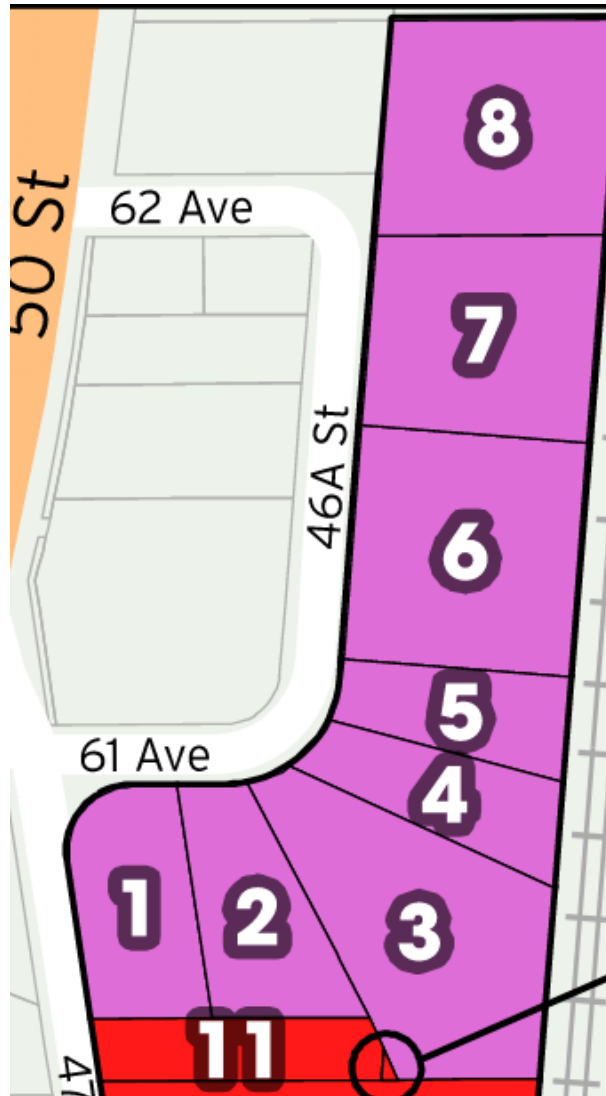

Engagement Process & What We Heard

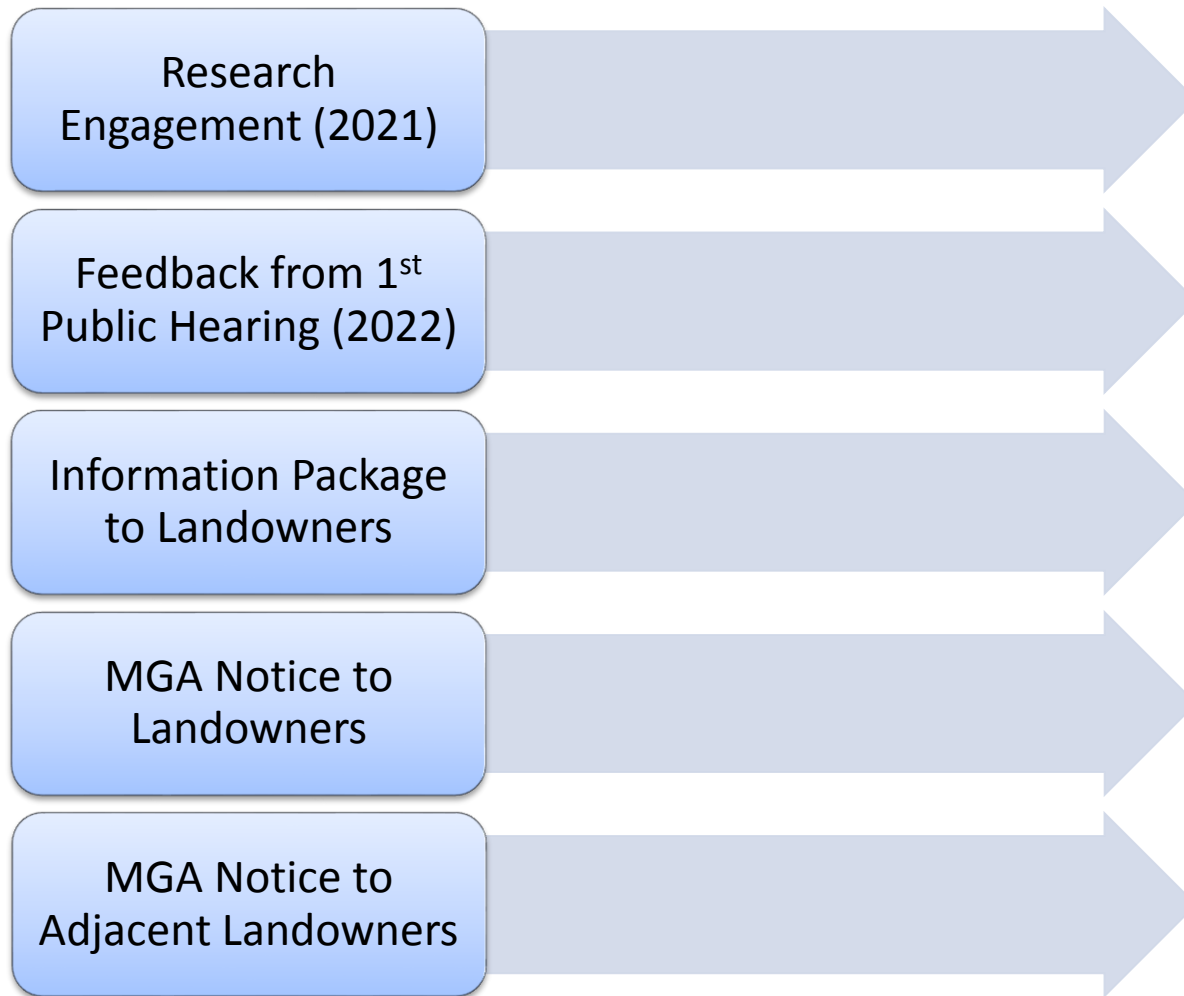

What We Heard - CSC to GC

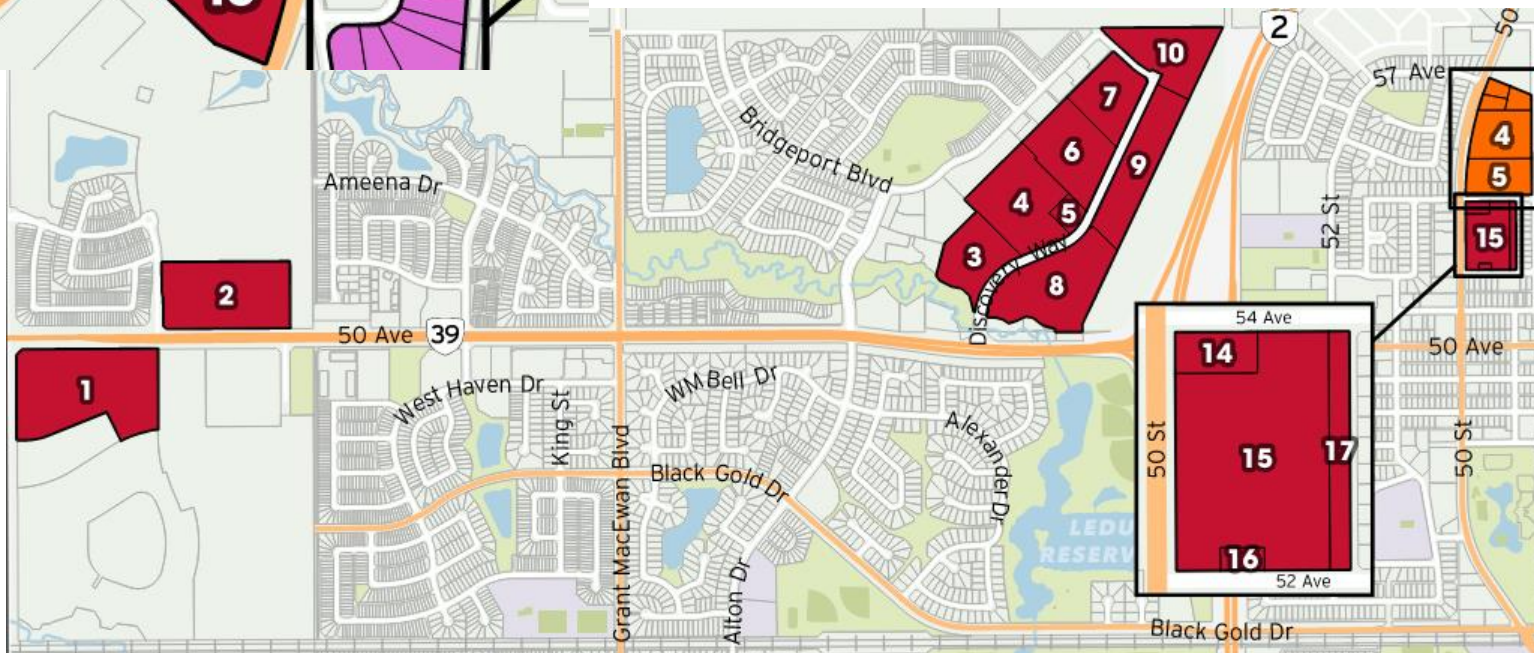
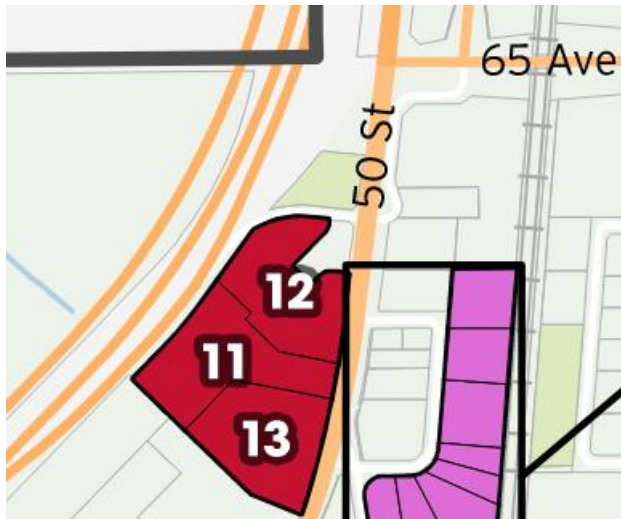

What We Heard - IL to GC

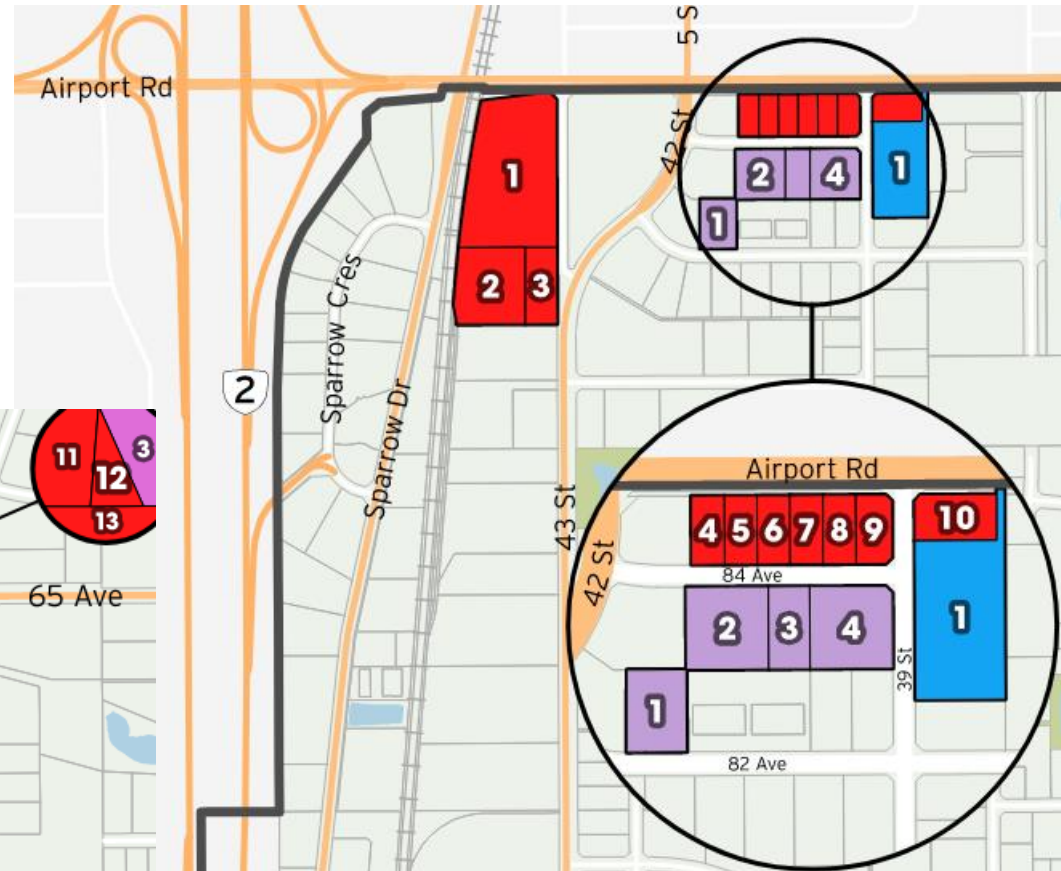
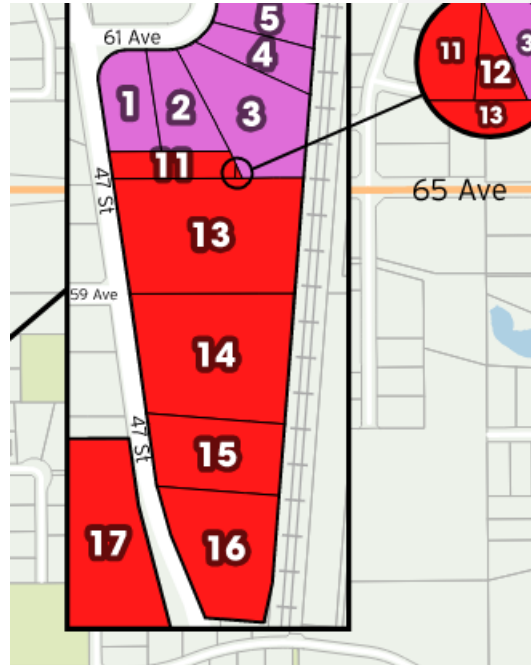
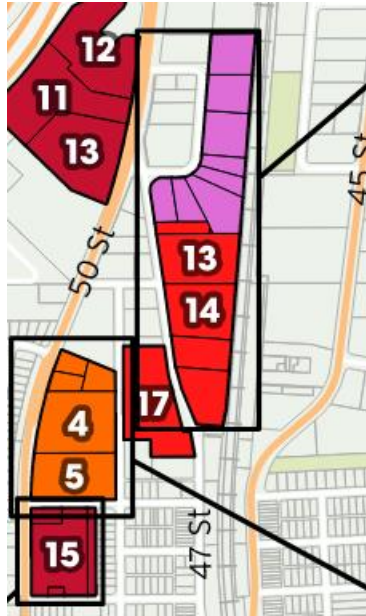

What We Heard - CBD to GC

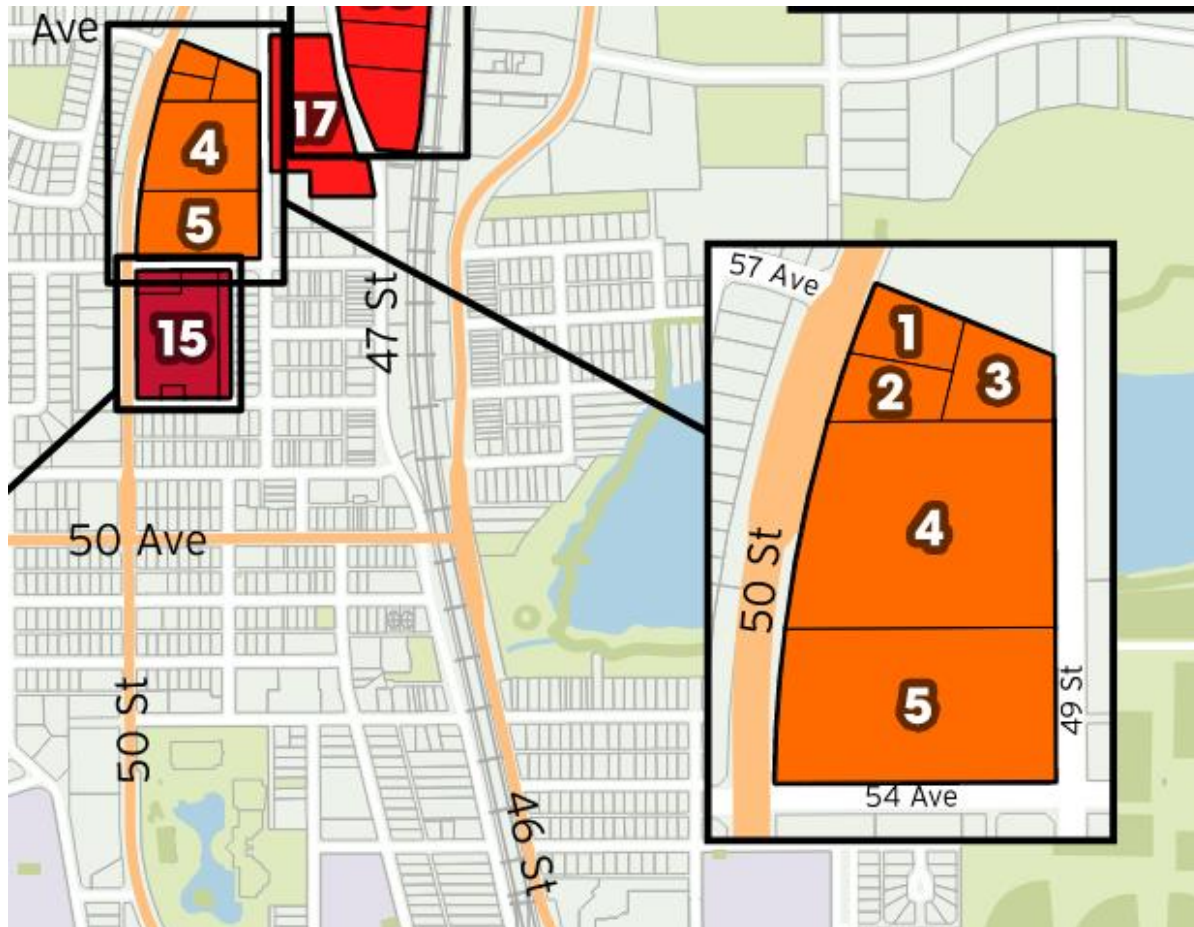

What We Heard - IM to IL

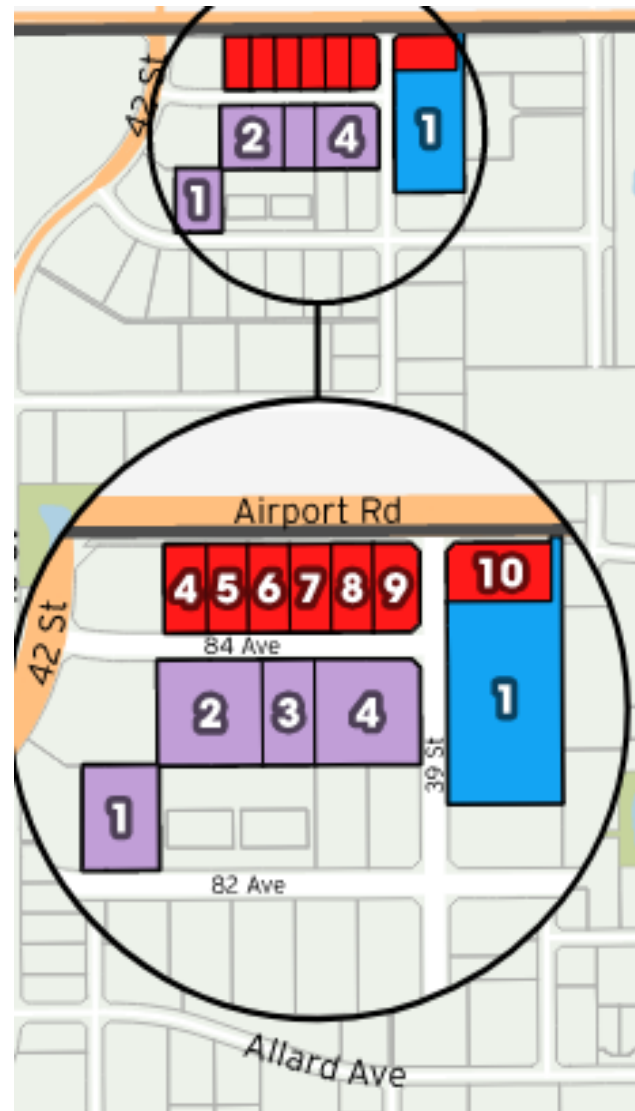

What We Heard - IBL to GC

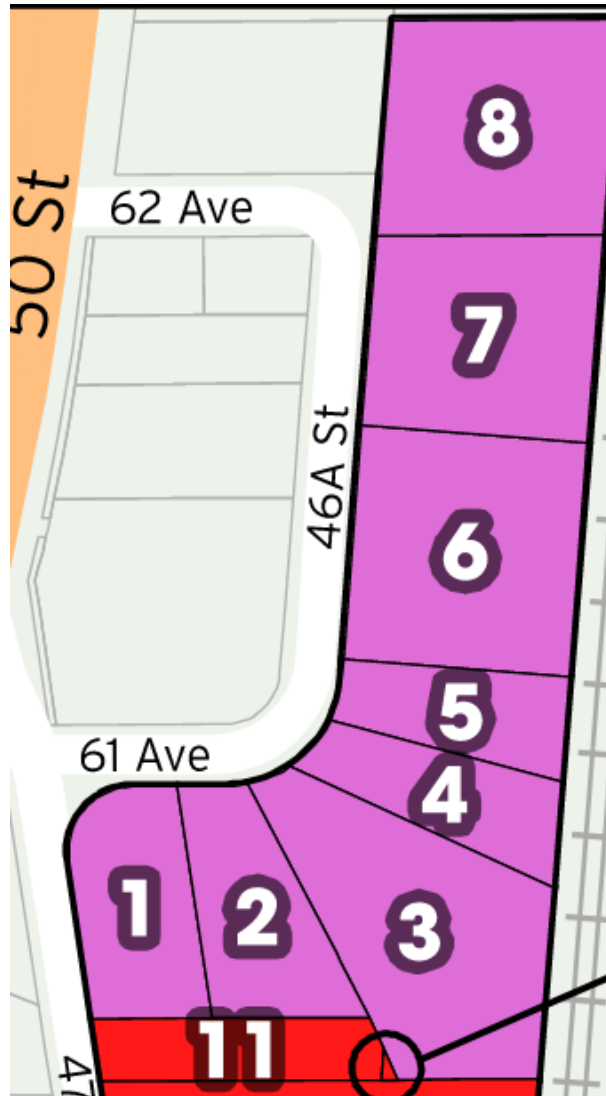

Administration Proposes

That, properties within Attachment 2, IL to GC parcels 4 to 9 be withdrawn from the amending Bylaw.

Administration proposes to undertake additional consultation with the property owners.

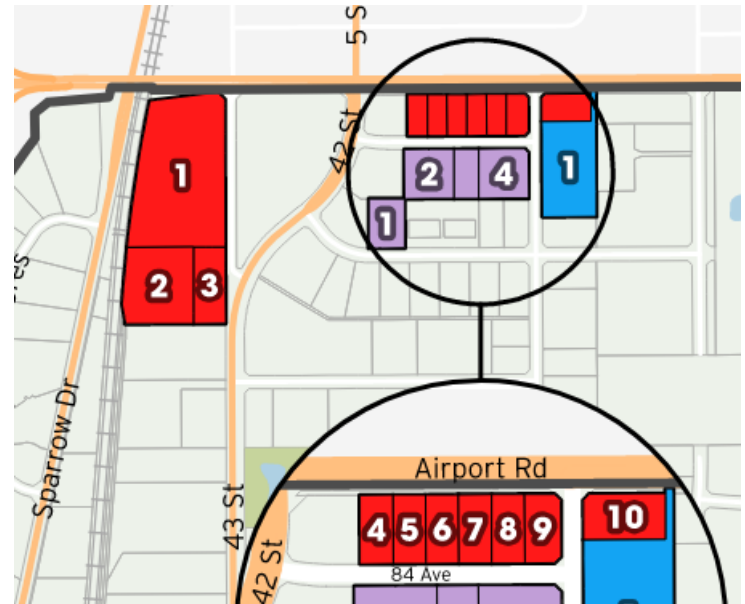

Questions?



Industrial Zone Review Project

Amendment to Land Use Bylaw

Bylaw No. 1171-2024

www.leduc.ca

